



Rotary Switch (For Heater Fan & Oven)



SPECIFICATION

RATING	: 10.1A 125VA (UL,C-UL)
INSULATION RESISTANCE	: DC 500V 100MΩ OR MORE
CONTACT RESISTANCE	: DC 2-4V 1A 30mΩ OR LESS
WITHSTAND VOLTAGE	: AC 1500V FOR 1 Min



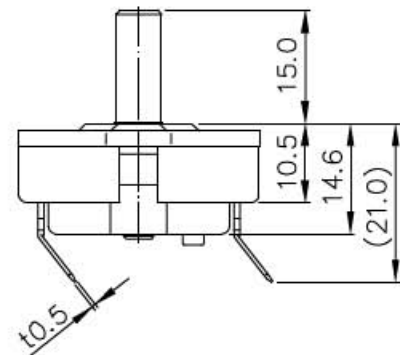
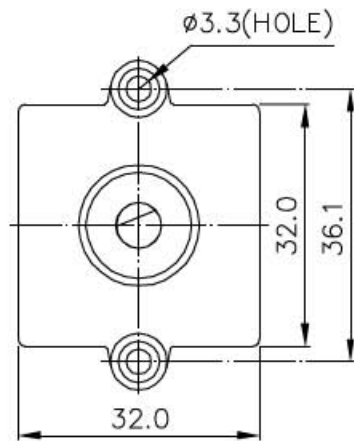
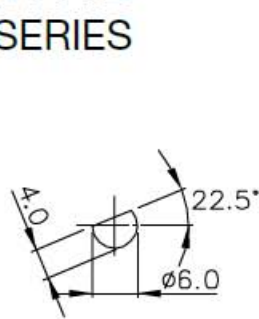

2144B SERIES

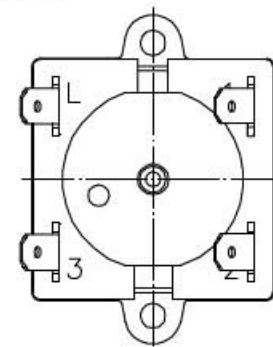
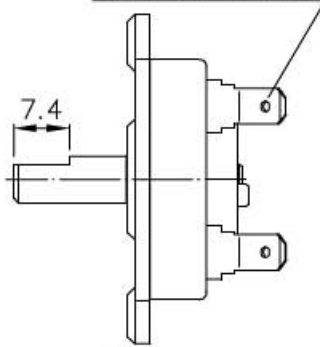

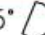

#187 FAST-ON TERMINAL

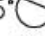

C03

- 45°  1 POS. L-1(Momentary-on)
- 0°  2 POS. 1-2
- 45°  3 POS. L-3
- 90°  4 POS. L-1

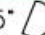
C04

- 45°  1 POS. L-1
- 0°  2 POS. 1-2 (OFF)
- 45°  3 POS. L-3