



SPECIFICATION



RATING	: 12(4)A 250V~ T85 (UL,C-UL,ENEC) 8/128A 250V~ T85 (UL,C-UL,ENEC) (128A CAPACITIVE 10,000 OPERATIONS)
INSULATION RESISTANCE	: DC 500V 100MΩ OR MORE
CONTACT RESISTANCE	: DC 2-4V 1A 20mΩ OR LESS
WITHSTAND VOLTAGE	: AC 1500V FOR 1 Min
AMBIENT TEMPERATURE	: 0 °C TO 85 °C
ELECTRICAL LIFE	: 10,000 CYCLES

3026 SERIES

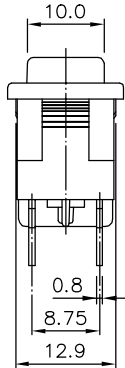
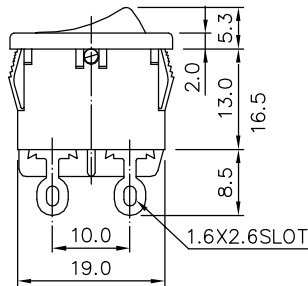
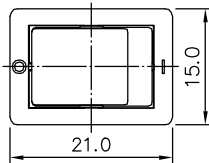

W	PANEL THICK
19.2	0.75 ~ 1.25
19.4	1.25 ~ 2.00
19.8	2.00 ~ 3.00

MOUNTING HOLE
(FOR REFERENCE)

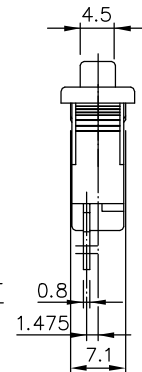
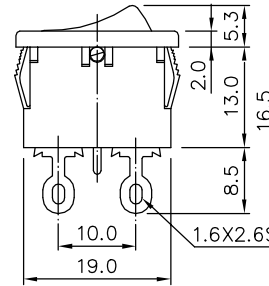
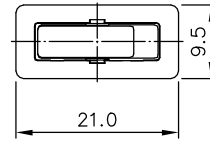
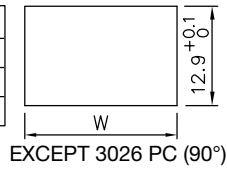

W	PANEL THICK
19.2	0.75 ~ 1.25
19.4	1.25 ~ 2.00
19.8	2.00 ~ 3.00

MOUNTING HOLE
(FOR REFERENCE)

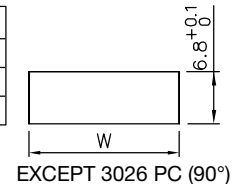

HOW TO ORDER

3026 - □ - □ - □ - □ - □ - □ - □

